



KLICPEROVO DIVADLO HRADEC KRÁLOVÉ

**KLICPERA'S THEATRE HRADEC KRÁLOVÉ
CZECH REPUBLIC**

**Dlouha 99, 500 01 Hradec Kralove
Phone 495 514 590-1; FAX 495 513 782**

TECHNICAL GUIDE

<http://www.klicperovodivadlo.cz/>
[mailto: theatre@klicperovodivadlo.cz](mailto:theatre@klicperovodivadlo.cz)

KLICPEROVO DIVADLO
HRADEC KRÁLOVÉ

MAIN STAGE

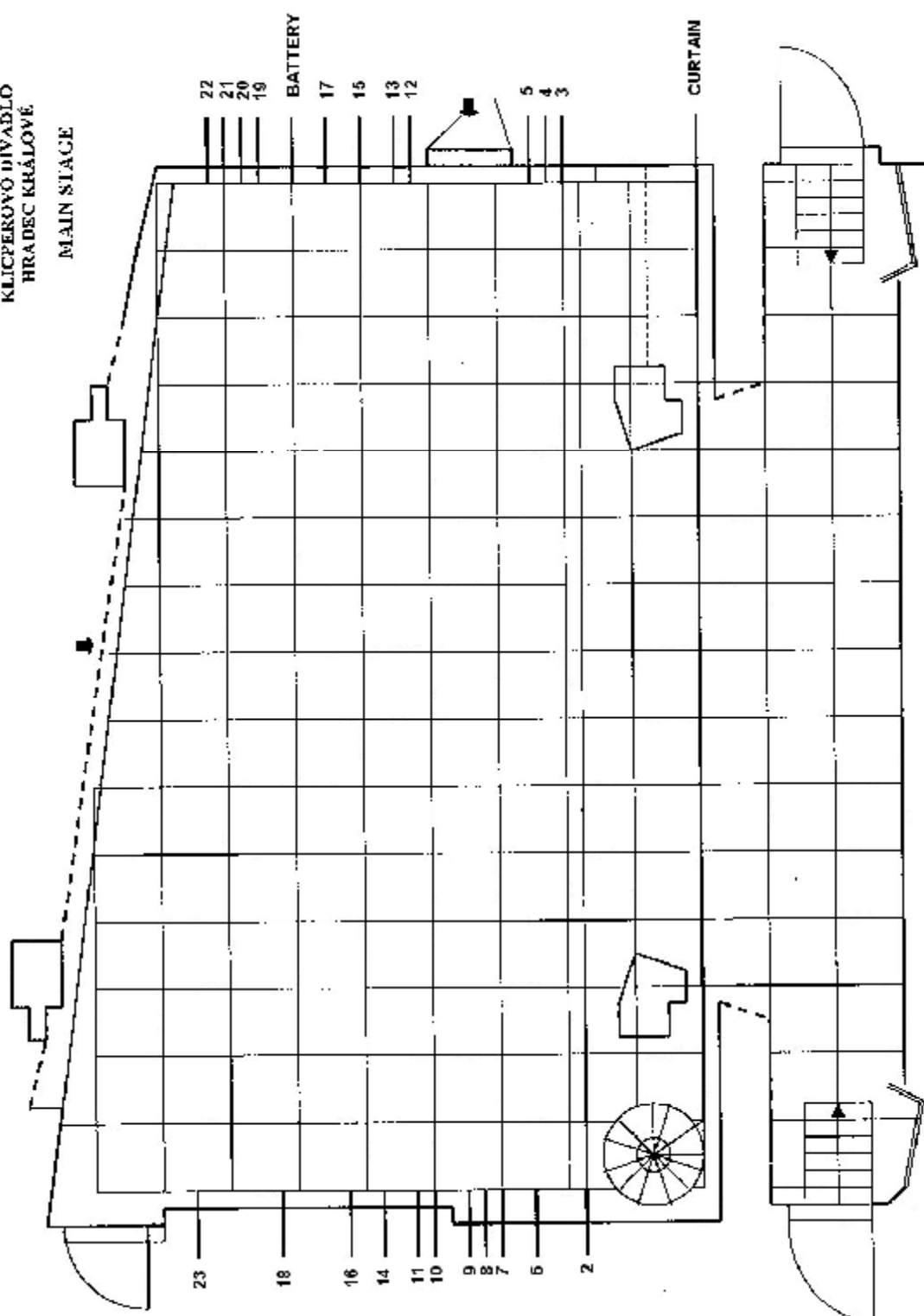

Klicpera's theatre
Hradec Králové
main stage

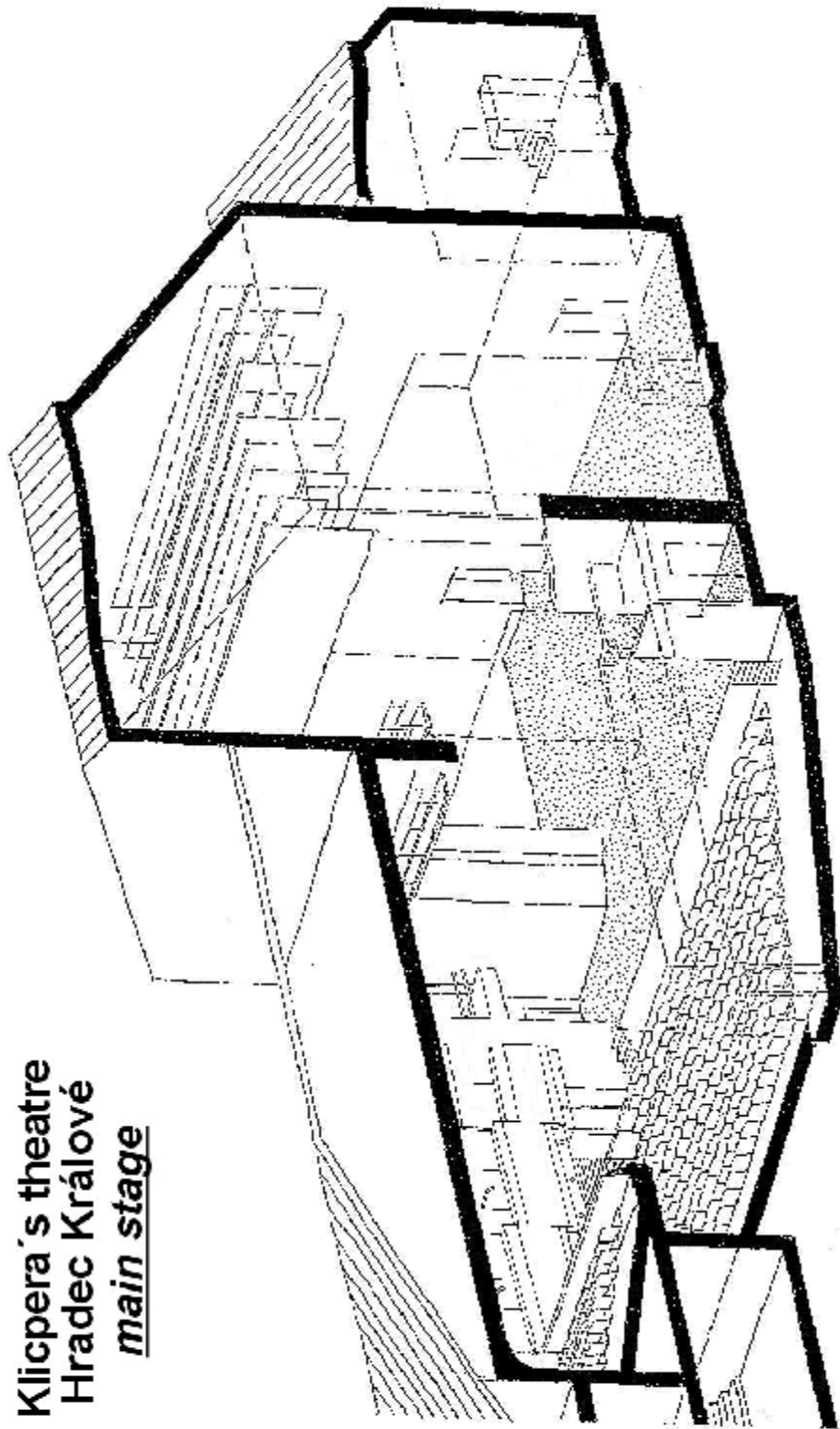

Stage: 8 X 7 m
Stage with proscenium: 14 X 7 m
Auditorium: 407 places
Portal height: 5,4 m
Portal width: 8 m

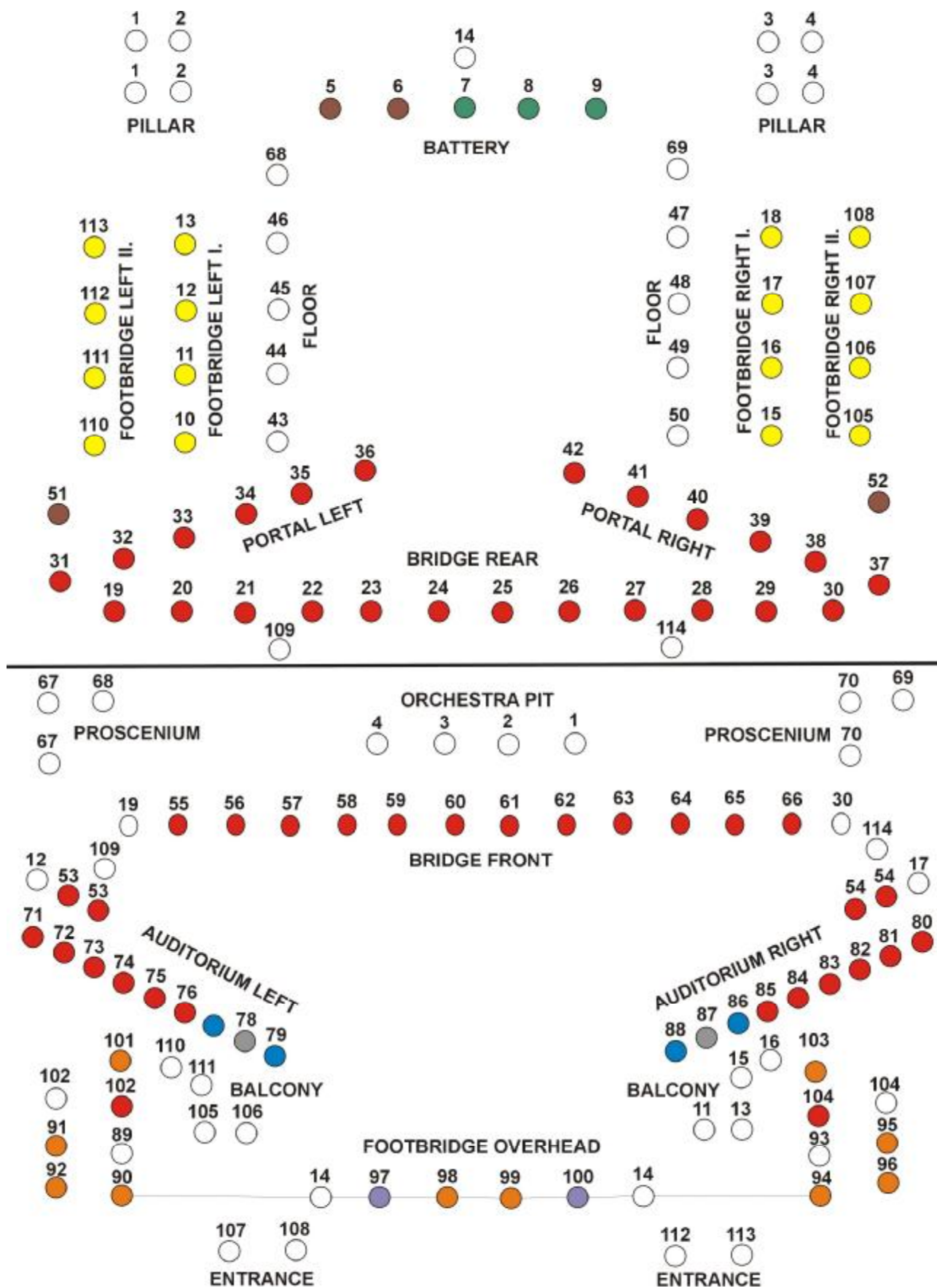

- SPOTLIGHTS FHR - 1000 W
- LUMINAIRE 220/24 V - 250 W
- SPOTLIGHTS GHR - 1000 W
- FILL LIGHTS - 1000 W
- FOLLOWSPOTS ADB - 1200 W
- BATTERY - 2250 W
- PROFILES ETC - 750 W
- SPOTLIGHTS FHR - 2000 W
- REGULATED ELECTRIC OUTLET

LIGHTNING CONTROL SYSTEMS

STRAND 520i

BACKUP SYSTEM 144

Contact:
Light system: Mr. Václav Mazánek
+420 495 514 590

AUDIO / MATERIEL SON

Dear friends sound engineers,

I am sending you basic information about the sound system you will find in the main building of the Klicpera Theatre.

Sound distribution in the hall is stereo. It consists of loudspeakers series Waveforce YAMAHA Co. The system is designed in such a way that the stereo effect can be heard at the whole auditory. Maximum output is about 3 kW.

Sound distribution on stage (monitors) is performed using three pairs of loudspeakers, i. e. the forestage, the middle of the stage and backstage. Monitoring ways go via AUX.

The layout of external inputs and outputs on the stage: All is connected symmetrically. Front portals (LFP, RFP) include 8 inputs and 4 outputs each, back portals (LBP, RBP) include 6 inputs and 2 outputs each, the orchestra pit includes 12 inputs and 4 outputs (all connectors are XLR type). There are even 24 XLR inputs and 8 JACK 6.3 mm outputs for connecting ports and other presentation equipment.

The sound booth is behind the last row of seats in the stalls under the dress circle along the whole width of the auditory. The audio mixer is in the middle so there is a direct contact with the hall and sound.

The audio mixer consists of two YAMAHA DM 1000 consoles and it is connected in concatenation (cascade):

- 32 symmetrical inputs
- 8 AUX outputs
- 2 effect banks on each console
- compressor, limiter

Professional DENON minidisks are used as **presentation mixers**. There are three mixers in the booth.

So I think this is all that I can tell you about the sound system. In case of other requirements you can phone us and we will help you.

I am looking forward to our future cooperation.

Yours sincerely

Contact:
Sound system: Mr. Viktor Borovský
+420 495 514 590